



Our Lady of the Rosary School Caloundra Internal Traffic Management Plan

Drop off/Pick up area for students.

Entry and exit to the school drop off zone is along Alfred Street. Entry is via the eastern end and is single line one-way traffic.

Drop off zone is alongside the staff car park. Parents are not allowed to park in the staff carpark and must follow the clearly marked lines and stopping bays only.

Children must get in and out of the car via the left side of the vehicle only.

A staff member is on duty to assist at both drop off and pick up and supervise children arriving by bus and waiting for bus pick up in the afternoon.

Designated pedestrian crossings are located at the entry and exit of the staff carpark and through the carpark from the footpath/bus stop area along Alfred Street to the school. See attached diagram.

Pedestrian walkways are protected from roadways by fencing.

Parent Parking

Parking is available in the large carpark along Edmund Street. Entry is via Edmund Street with one-way signage to the exit on Edmund Street.

Disabled parking is available in this carpark.

A pedestrian crossing is located at the exit of the carpark. It follows along the footpath down towards the school crossing along Edmund Street. A staff member is on duty at this crossing after school. A school crossing supervisor is on duty before and after school at the Edmund Street pedestrian crossing.

Street parking is also available along Edmund and Alfred Streets.

Courier and delivery drop off points.

Standard deliveries are via the Edmund Street carpark.

Deliveries are brought to reception before being delivered to other areas of the school.

Deliveries which require use of the staff carpark are to call in advance to notify their arrival. If required a staff member will assist in escorting the driver.

Deliveries onto the oval will be escorted by a staff member at all times and only proceed outside school playtime. If the delivery is to take an extended amount of time the vehicle and area will be cordoned off.

Safe passage of vehicles within the school

The following safety arrangements are in place when large vehicles or mobile plant are required to move around the school.

Vehicles are not allowed to move around the school grounds during peak traffic times, before and after school and during lunch breaks.

Worksite speed limits are set at 10km/hr.



Our Lady of the Rosary School Caloundra Internal Traffic Management Plan

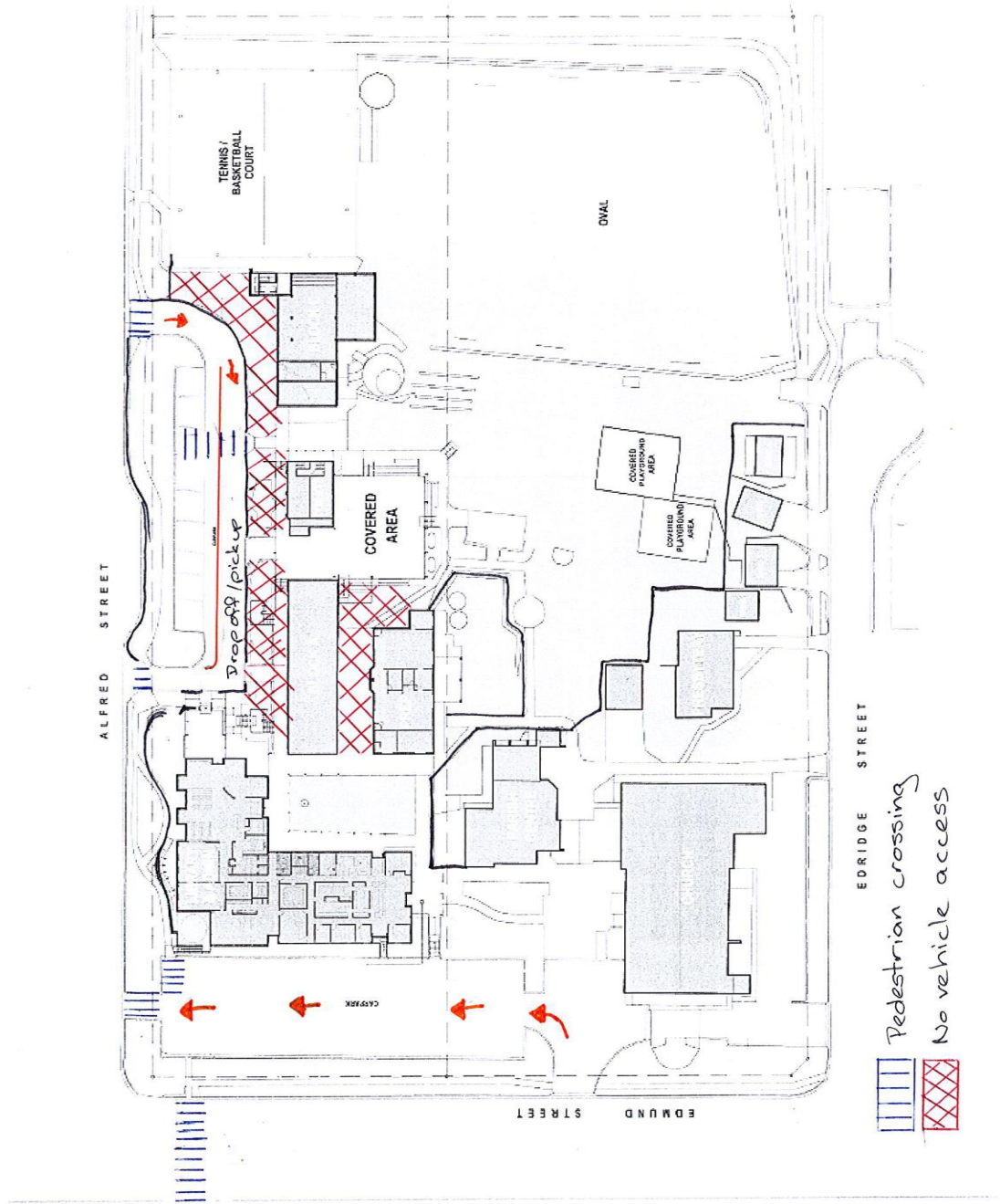

Signatures

Principal Michael Stewart		09.11.20
WHSO Johanna Castle		09.11.20

